

17,264 (1)



# Farmers Electric Cooperative

2000 I-30 E  
Greenville, TX 75402

FILED FOR RECORD  
at 1:00 o'clock P M

FEB 08 2022

BECKY LANDRUM  
County Clerk, Hunt County, Tex.  
By 

Thursday, January 20, 2022

Office of Hunt County Commissioners  
PO BOX 1097  
Greenville TX 75403

**Farmers Electric Cooperative Member: CURTIS CROW**  
**Service Order Number: 2022013105**

Greetings:

Farmers Electric Cooperative, Inc. is requesting permission to construct electrical power distribution facilities which will cross County Road 3229 which is located 1830 ft north of CR 3229 in Hunt County, Texas.

Site location map and construction sketches are enclosed. The construction sketch details the proposed work. All road crossings will have a minimum vertical clearance of 22 feet.

If you have any questions, please contact me at any time.

Sincerely,

*Colton McDonald*

Project Coordinator  
cmcdonald@farmerselectric.coop  
Phone 903-513-9024

Submitted by Brandon Darrow  
bdarrow@farmerselectric.coop  
Field Engineering Coordinator

Enclosures



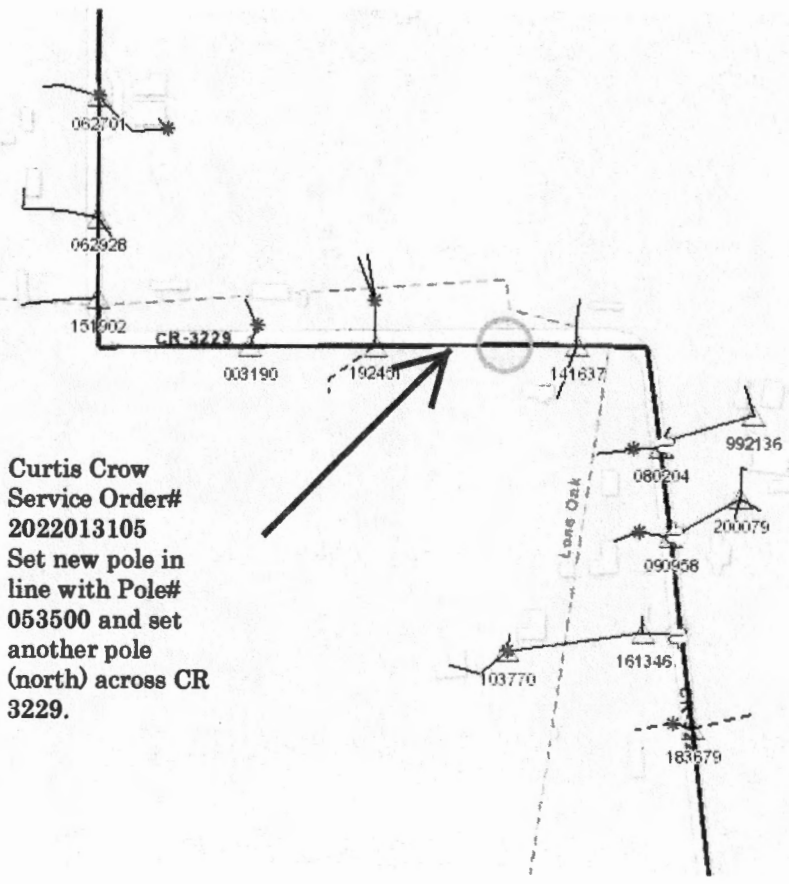

**Curtis Crow**  
**Service Order#**  
**2022013105**  
**Set new pole in**  
**line with Pole#**  
**053500 and set**  
**another pole**  
**(north) across CR**  
**3229.**

17,264 (2)



2000 I-30 E  
Greenville, TX 75402

FILED FOR RECORD  
at 1:00 o'clock P M

FEB 08 2022

BECKY LANDRUM  
County Clerk, Hunt County, Tex.  
By

Monday, January 24, 2022

Office of Hunt County Commissioners  
PO BOX 1097  
Greenville TX 75403

Farmers Electric Cooperative Member: Judy Martin  
Service Order Number: 2021126412

Greetings:

Farmers Electric Cooperative, Inc. is requesting permission to construct electrical power distribution facilities which will cross County Road 3520 which is located 2100' SE OF FM 2101 in Hunt County, Texas.

Site location map and construction sketches are enclosed. The construction sketch details the proposed work. All road crossings will have a minimum vertical clearance of 22 feet.

If you have any questions, please contact me at any time.

Sincerely,

*Cody Bland*

Project Coordinator  
cbland@farmerselectric.coop  
Phone 903-456-1722

Submitted by Psalm Harper  
pharper@farmerselectric.coop  
Field Engineering Coordinator

Enclosures

County Approval Section:

Approved:  Denied:

Authorized Signature:

Date: 2-8-22

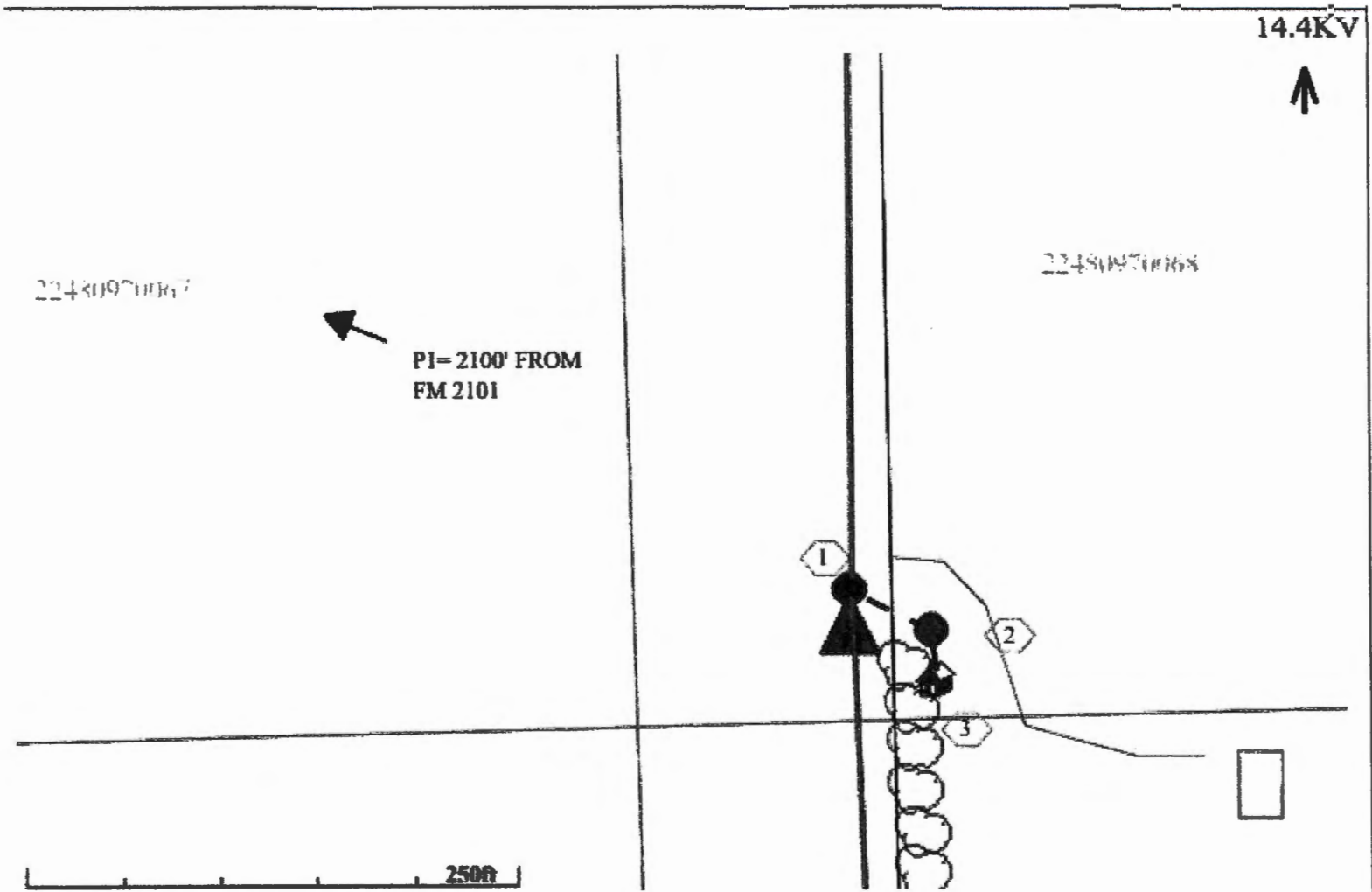

14.4KV



22480970067

22480970068



P1= 2100' FROM  
FM 2101

1

2

3

250ft

22480970068

CROSSING CR 3520 AT POLE 025213 WHICH  
IS 2100' SE OF  
FM 2101

**LONE OAK ISD**

025213  
9302

75474